

Part number

# CMAP 06 CP



Surface mounting housing, 830V series, with 4 pegs, Pg21 cable entry, size "77.27", high construction, with plastic cover

Product description	
<b>Product type</b>	Surface mounting housing
<b>Series</b>	830V
<b>Closing type</b>	With 4 pegs
<b>Size</b>	Size 77.27
<b>Cable entry</b>	With cable entry Pg21
<b>Specification</b>	High construction, with plastic cover
Technical data	
<b>IP degree of protection</b>	IP65
Further technical details	
<b>Operating temperature range (min, max)</b>	-40°C...+125°C

Material properties	
<b>Colour</b>	RAL 7040 grey
<b>RoHs conformity</b>	Compliant
<b>China RoHs - EFUP</b>	E
<b>REACH SVHC substances</b>	No
Approvals / Standards	
<b>Certifications</b>	DNV, BV
<b>UL</b>	ECBT2
<b>cUL</b>	ECBT8
General ordering information	
<b>EAN13 code</b>	8015747029186
Packaging Information	
<b>Sub-packaging description</b>	Plastic packaging
<b>Sub-packaging quantity</b>	5 Pcs
<b>Sub-packaging EAN barcode</b>	8015747104470

Part number

# CMAP 06 CP



Catalogue drawings

## CMP CMAP - MMP MMAP

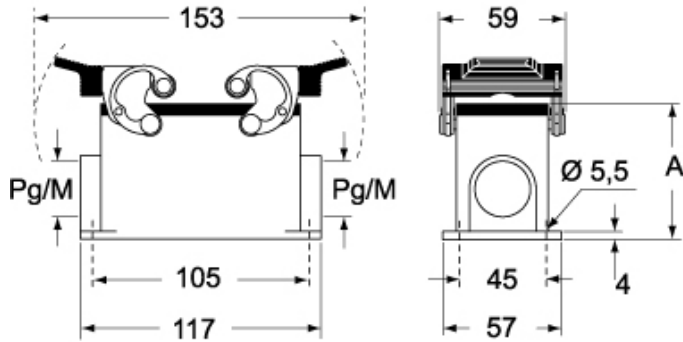

## CMP CS/CP CMAP CS/CP - MMP CS/CP MMAP CS/CP

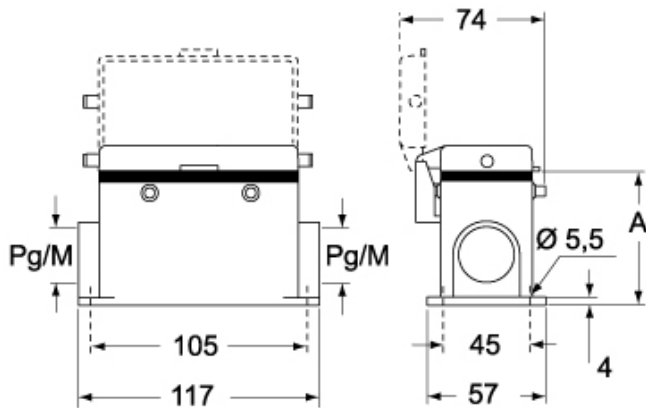

	A
<b>CMP / MMP</b>	63
<b>CMAP / MMAP</b>	77
<b>CMP CS / MMP CS</b>	63
<b>CMAP CS / MMAP CS</b>	77
<b>CMP CP / MMP CP</b>	63
<b>CMAP CP / MMAP CP</b>	77