

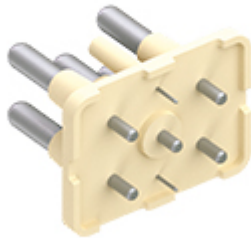

Part number

# CIF Q4/2 2.4



Interface for printed circuit, 4 poles + PE, for up to 2,4 mm thick PCB



|   |   |                                     |   |
|---|---|-------------------------------------|---|
| <b>Product description</b>                    |   | <b>Material properties</b>          |   |
| <b>Product type</b>                           | Interface for printed circuit   | <b>Main material</b>                | Polycarbonate (PC)  |
| <b>N. of poles</b>                            | 4 poles +  | <b>Other materials</b>              | Contacts: copper alloy  |
| <b>Specification</b>                          | For CQ 04/2 inserts<br>For up to 2,4 mm thick PCB   | <b>Colour</b>                       | RAL 7032 grey   |
| <b>Technical data</b>                         |   | <b>RoHs conformity</b>              | Compliant with exemption<br>6(c): copper alloy containing up to 4% lead by weight |
| <b>Current</b>                                | 30 A  | <b>China RoHs - EFUP</b>            | 50  |
| <b>Voltage</b>                                | 400 - 690 V   | <b>REACH SVHC substances</b>        | Yes<br>Lead   |
| <b>Rated impulse withstand voltage</b>        | 6 kV  | <b>SCIP number</b>                  | 022a8a72-7a4c-443a-a1ad-2461ccc7884c  |
| <b>Pollution degree</b>                       | 2   | <b>Approvals / Standards</b>        |   |
| <b>Contact type</b>                           | Turned silver plated  | <b>Certifications</b>               | DNV   |
| <b>Further technical details</b>              |   | <b>UL</b>                           | ECBT2   |
| <b>Characteristics according to EN 61984</b>  | 30A 400/690V 6kV 2; 7,5A 250V 4kV 2   | <b>cUL</b>                          | ECBT8   |
| <b>Contact resistance</b>                     | ≤ 3 mΩ  | <b>General ordering information</b> |   |
| <b>Weight</b>                                 | 15,00 g   | <b>EAN13 code</b>                   | 8015747252355   |
| <b>Operating temperature range (min, max)</b> | -40°C...+125°C  | <b>eCl@ss 8.1</b>                   | 27449290  |
| <b>UL 94 flammability rating</b>              | UL 94 V-0   | <b>ETIM 7.0</b>                     | EC002943  |
|   |   | <b>Packaging Information</b>        |   |
|   |   | <b>Packaging length</b>             | 180,00 mm   |
|   |   | <b>Packaging height</b>             | 120,00 mm   |
|   |   | <b>Packaging width</b>              | 155,00 mm   |
|   |   | <b>Packaging weight</b>             | 1,07 kg   |
|   |   | <b>Packaging volume</b>             | 3,35 dm <sup>3</sup>  |
|   |   | <b>Packaging description</b>        | Carton box  |
|   |   | <b>Packaging quantity</b>           | 60 Pcs  |
|   |   | <b>Packaging EAN code</b>           | 8015747252362   |
|   |   | <b>Sub-packaging length</b>         | 35,00 mm  |
|   |   | <b>Sub-packaging height</b>         | 40,00 mm  |
|   |   | <b>Sub-packaging width</b>          | 155,00 mm   |
|   |   | <b>Sub-packaging weight</b>         | 0,18 kg   |
|   |   | <b>Sub-packaging volume</b>         | 0,22 dm <sup>3</sup>  |
|   |   | <b>Sub-packaging description</b>    | Carton tray   |
|   |   | <b>Sub-packaging quantity</b>       | 10 Pcs  |
|   |   | <b>Sub-packaging EAN barcode</b>    | 8015747252379   |

Part number

# CIF Q4/2 2.4



Catalogue drawings

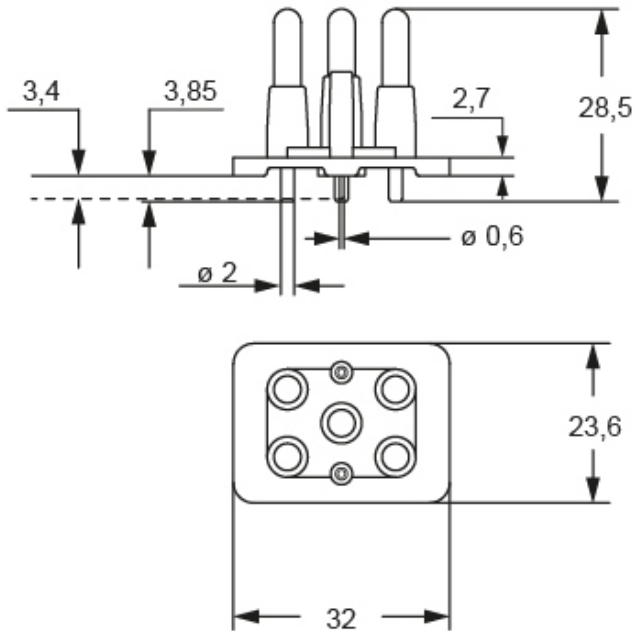

PCB-Layout

