

Part number

CHPT 10.4 LS



Surface mounting housing, C-TYPE series, with 1 lever, 1/2" NPT cable entry, size "57.27", with metal cover

| Product description | | Material properties | |
|-----------------------------------------------|------------------------------|-------------------------------------|-------------------------------------------------------|
| Product type | Surface mounting housing | Other materials | Lever: Stainless steel, polyamide (PA) Gasket: NBR |
| Series | C-TYPE | Colour | RAL 7040 grey |
| Closing type | With 1 lever | RoHs conformity | Compliant |
| Size | Size 57.27 | China RoHs - EFUP | E |
| Cable entry | With cable entry 1/2" NPT | REACH SVHC substances | No |
| Specification | With metal cover | Approvals / Standards | |
| Technical data | | Certifications | DNV, BV |
| IP degree of protection | IP65 / IP66 / IP69 | UL | ECBT2 |
| Further technical details | | cUL | ECBT8 |
| Weight | 295,00 g | General ordering information | |
| Operating temperature range (min, max) | -40°C...+125°C | EAN13 code | 8015747114288 |
| | | Packaging Information | |
| | | Packaging length | 475,00 mm |
| | | Packaging height | 170,00 mm |
| | | Packaging width | 150,00 mm |
| | | Packaging weight | 3,36 kg |
| | | Packaging volume | 12,11 dm ³ |
| | | Packaging description | Carton box |
| | | Packaging quantity | 10 Pcs |
| | | Packaging EAN code | 8015747114417 |
| | | Sub-packaging weight | 1,68 kg |
| | | Sub-packaging description | Plastic packaging |
| | | Sub-packaging quantity | 5 Pcs |
| | | Sub-packaging EAN barcode | 8015747114424 |

Part number

CHPT 10.4 LS



Catalogue drawings

CHP L - CAP L MHP L - MAP L

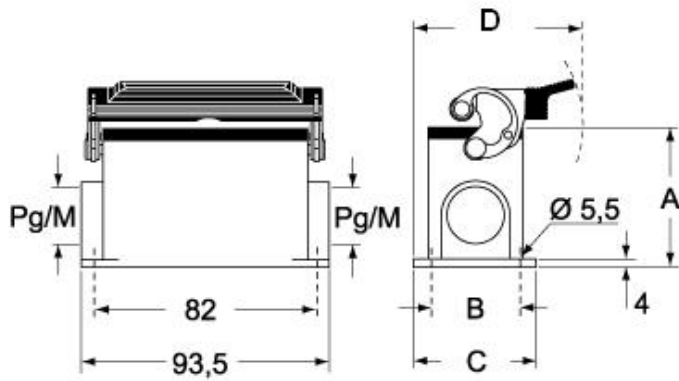

CHP LS - CAP LS MHP LS - MAP LS

