

Part number  
**BK 3295**



Interlocked switched socket-outlet, BK series, 3 poles + N + PE, 9 h (blue), 32 A, 120/208 ÷ 144/250 V, sectionable fuse carrier 10 x 38 mm

Product description		Material properties	
<b>Product type</b>	Interlocked switched socket-outlet	<b>Colour</b>	RAL 7035 grey, RAL 5015 blue
<b>Series</b>	BK		Compliant with exemption 6(c): copper alloy containing up to 4% lead by weight
<b>N. of poles</b>	3 poles + N + 	<b>RoHs conformity</b>	50
<b>Clock position</b>	9	<b>China RoHs - EFUP</b>	50
<b>Size</b>	Socket centre distance 114 x 228 mm	<b>REACH SVHC substances</b>	Yes Lead
<b>Specification</b>	Sectionable fuse carrier 10 x 38 mm	<b>SCIP number</b>	F6799547-ab84-42f2-938f-233ba663766d
Technical data		Approvals / Standards	
<b>Current</b>	32 A	<b>Reference standard</b>	EN 60309-1, -2 e -4
<b>Voltage</b>	120/208 ÷ 144/250 V	General ordering information	
<b>IP degree of protection</b>	IP67	<b>EAN13 code</b>	8015747005043
Further technical details		Packaging Information	
<b>Weight</b>	1.420,00 g	<b>Sub-packaging length</b>	116,00 mm
<b>Operating temperature range (min, max)</b>	-25°C ... +40°C	<b>Sub-packaging height</b>	130,00 mm
<b>IK rating (impact degree of protection)</b>	IK10	<b>Sub-packaging width</b>	230,00 mm
		<b>Sub-packaging weight</b>	1,42 kg
		<b>Sub-packaging volume</b>	3,47 dm <sup>3</sup>
		<b>Sub-packaging description</b>	Carton box
		<b>Sub-packaging quantity</b>	1 Pcs
		<b>Sub-packaging EAN barcode</b>	8015747005050

Part number

# BK 3295



Catalogue drawings

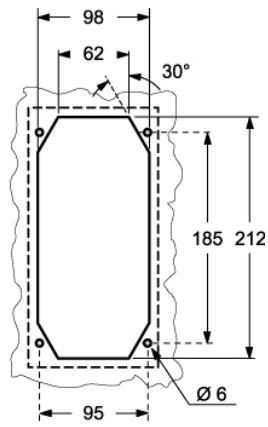
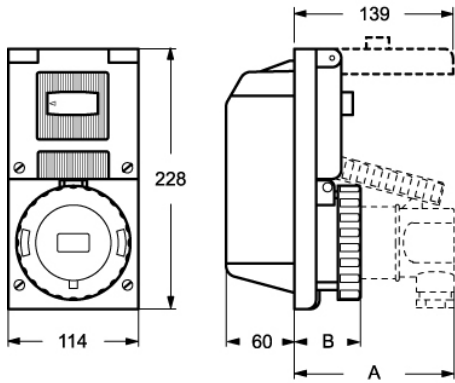

BK		A	B
16A	2P + ⊕	105	50
	3P + ⊕	105	50
	3P + N + ⊕	110	50
32A	2P + ⊕	140	58
	3P + ⊕	140	58
	3P + N + ⊕	140	58