

Part number

BK 1665



Interlocked switched socket-outlet, BK series, 3 poles + N + PE, 6 h (red), 16 A, 200/346 ÷ 240/415 V, sectionable fuse carrier 10 x 38 mm

Product description		Material properties	
Product type	Interlocked switched socket-outlet	Colour	RAL 7035 grey, RAL 3000 red
Series	BK		Compliant with exemption 6(c): copper alloy containing up to 4% lead by weight
N. of poles	3 poles + N + 	RoHs conformity	6(c): copper alloy containing up to 4% lead by weight
Clock position	6	China RoHs - EFUP	50
Size	Socket centre distance 114 x 228 mm	REACH SVHC substances	Yes Lead
Specification	Sectionable fuse carrier 10 x 38 mm	SCIP number	F6799547-ab84-42f2-938f-233ba663766d
Technical data		Approvals / Standards	
Current	16 A	Reference standard	EN 60309-1, -2 e -4
Voltage	200/346 ÷ 240/415 V	General ordering information	
IP degree of protection	IP67	EAN13 code	8015747004480
Further technical details		Packaging Information	
Weight	1.338,00 g	Packaging length	400,00 mm
Operating temperature range (min, max)	-25°C ... +40°C	Packaging height	300,00 mm
IK rating (impact degree of protection)	IK10	Packaging width	400,00 mm
		Packaging weight	13,50 kg
		Packaging volume	48,00 dm ³
		Packaging description	Carton box
		Packaging quantity	9 Pcs
		Packaging EAN code	8015747004497
		Sub-packaging length	116,00 mm
		Sub-packaging height	130,00 mm
		Sub-packaging width	230,00 mm
		Sub-packaging weight	1,50 kg
		Sub-packaging volume	3,47 dm ³
		Sub-packaging description	Carton box
		Sub-packaging quantity	1 Pcs
		Sub-packaging EAN barcode	8015747004503

Part number

BK 1665



Catalogue drawings

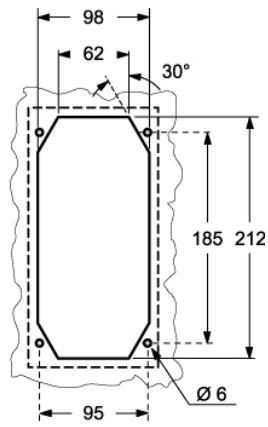
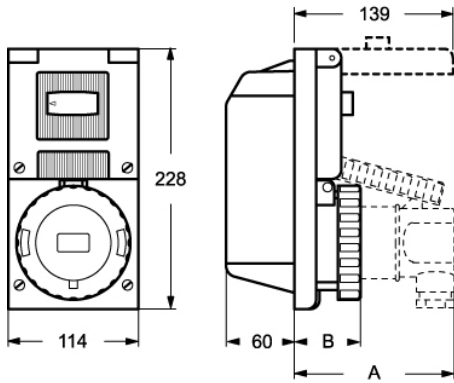

BK		A	B
16A	2P + ⊕	105	50
	3P + ⊕	105	50
	3P + N + ⊕	110	50
32A	2P + ⊕	140	58
	3P + ⊕	140	58
	3P + N + ⊕	140	58