



CAUTION:

- not for interrupting current
- for copper stranded wires only
- from 26 to 14 AWG (0,14 to 2,5 mm²)
- use with crimp contacts series **CD**, to be ordered separately
- use cable anchorage(s) **CX ... CA** according to cable Ø, to be ordered separately

ATTENTION:

- ne pas utiliser pour couper le courant
- employer seulement câbles flexibles en cuivre
- section de câbles à employer: N° 26 jusqu'à 14 AWG (de 0,14 jusqu'à 2,5 mm²)
- à utiliser avec contacts à sertir série **CD**, à commander séparément
- employer ancrage(s) **CX ... CA** suivant câble Ø, à commander séparément

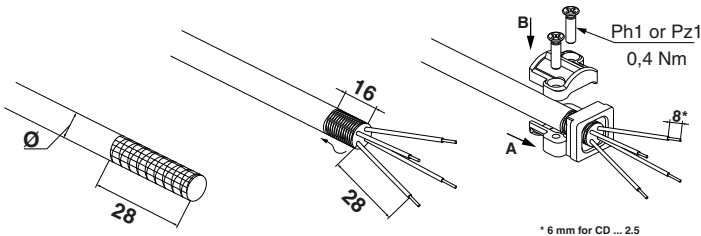

Cable Clamp Part No.	Ø mm	Size of screws	Tightening torque (Nm)	Recommended size of screwdriver
CX 5/7 CA	5...7	M 2,5	0,4	Ph1
CX 7/10 CA	7...10	M 2,5	0,4	Ph1
CX 10/12 CA	10...12	M 2,5	0,4	Ph1
CX 11/14 CA	11...14	M 2,5	0,4	Pz1

* 6 mm for CD ... 2.5

1

CX 08 D5F2

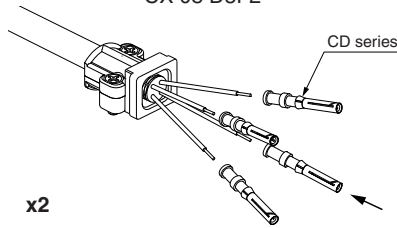

CX 08 D5M2

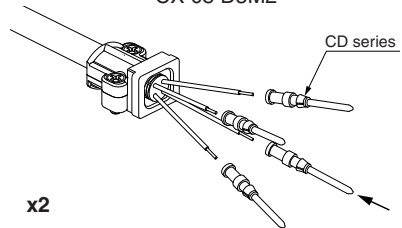

2

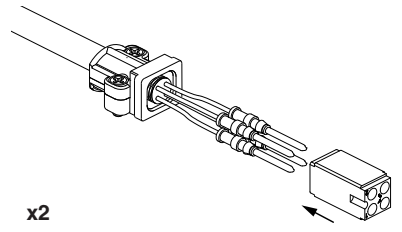
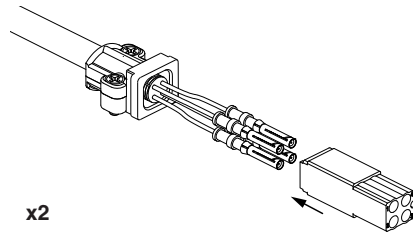

3

4

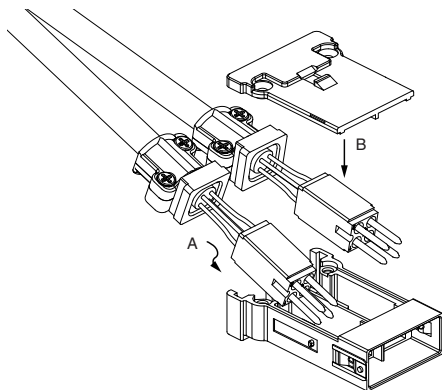
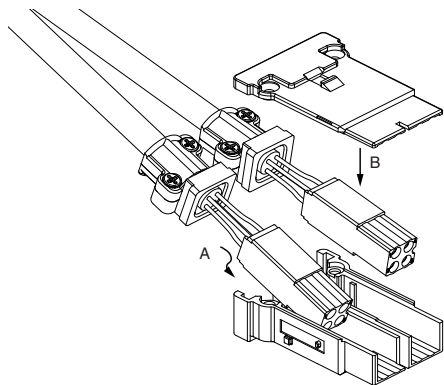

5

